

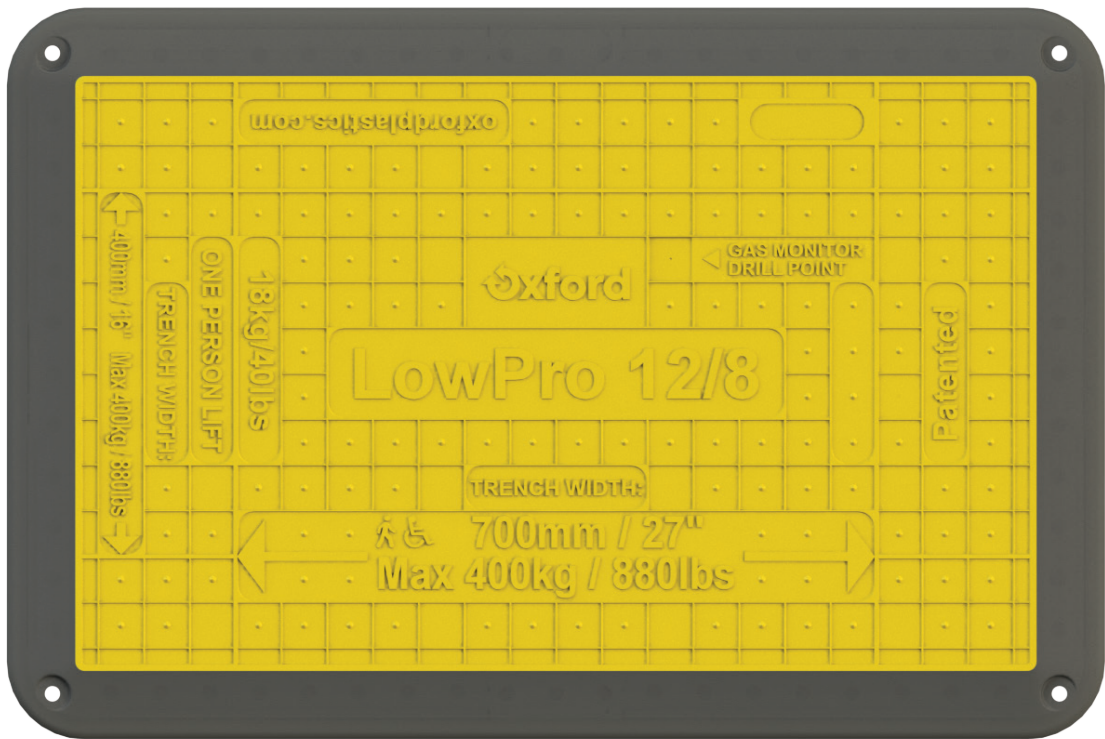

LOWPRO 12/8 TRENCH COVER





CONTENTS

PAGE

3	Features
4	Branding and customisation
5	Dimensions and weights
6	Material composition, product life and tracing
7	Load deflection data
8	Pedestrian usage only
9	Slip resistance
10	Inspection and maintenance
11	Installation and safe handling
12	Infills and Linking Plates
13	Infills Installation
14	Stillage
15	Associated Products
16	Trench Cover Guide
17	Code compliance
18	History of use
19	Composite Road Plate and Trench Cover Sales
20	Contact information





FEATURES

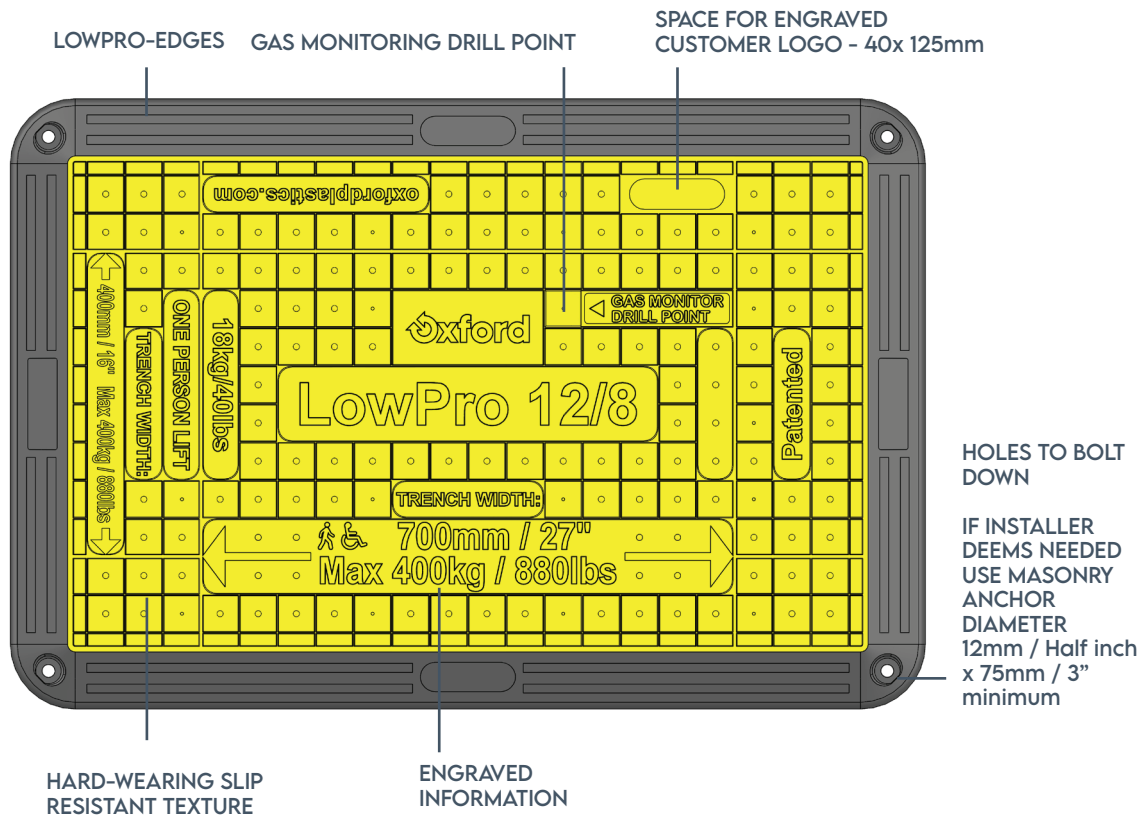

ROBUST

Advanced composite technology construction, robust and durable.

LowPro-edge prevents damage to asphalt, reduces noise, and stops board sliding.

Proven to be structurally safe in ambient temperatures of +50°C / 120°F to -30°C / -20°F. LowPro edges are more susceptible to damage in freezing temperatures.

Non-metal construction reduces theft.

SAFE & EASY TO USE

Can be manually handled without the need for heavy lifting equipment.

Quick to install.

Integral slip resistant texture.

Gas Monitoring drill point. Users can drill this area to allow gas measurements to be taken without removing the trench cover.

Can be bolted down.

EXTRAS

Can be customised with customer logos.

Colour customisable. MOQ's apply.

Infill pieces connect covers together to create a flat anti-trip platform.

Linking plates can be supplied to link units for added security.





BRANDING AND CUSTOMISATION

	Standard Colour	Non-standard Colours Available	Embossing
LowPro 12/8 Trench Cover	Yellow	Orange, Red, Blue, Purple & Green	MOQ 60 off
LowPro Stillage	N/A	N/A	N/A
Short Infill	N/A	N/A	N/A
Long Infill	N/A	N/A	N/A

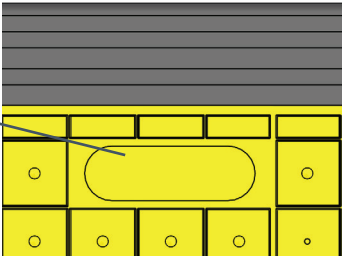
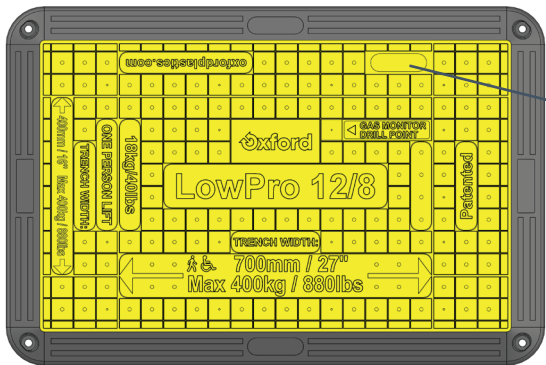

LowPro 12/8 Trench Cover
Custom Embossing Area
40 x 125mm

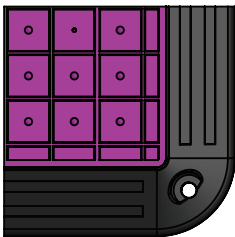
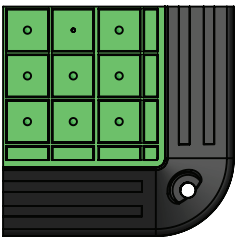
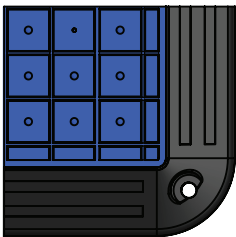
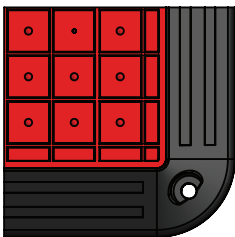
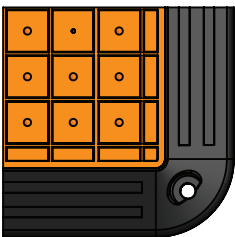
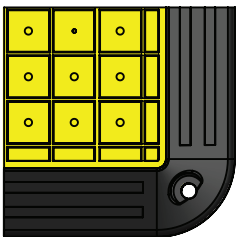

LowPro 12/8 Trench Cover Colour Options - MOQ 150 off





DIMENSIONS AND WEIGHTS

LOWPRO 12/8 TRENCH COVER 18Kg / 40lbs

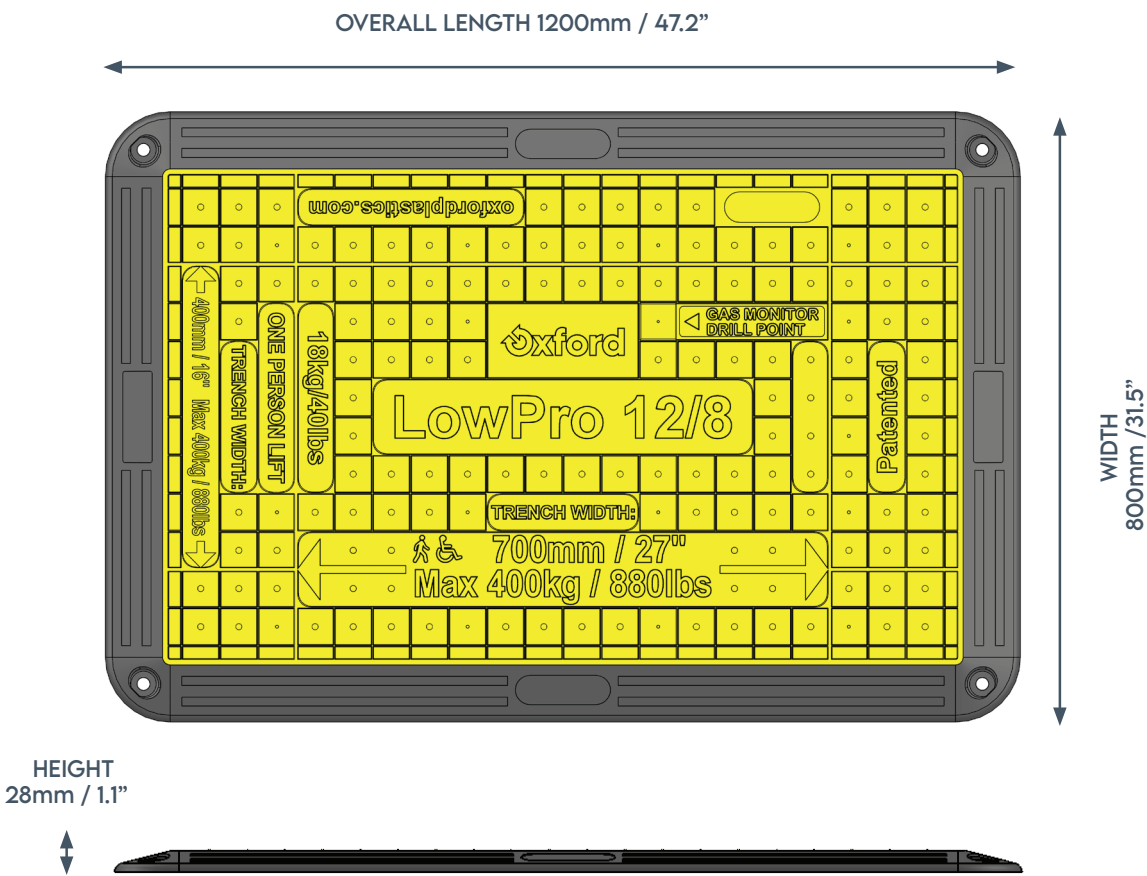

Part Name

LowPro 12/8 Footway Board

Product Code

O362





MATERIAL COMPOSITION AND PRODUCT LIFE

All elements use materials that if maintained correctly will not structurally degrade in UV light, in the presence of water or salts, and are stable in ambient temperatures from +50c / +120f to -30c / -20f. LowPro edges are more susceptible to damage in freezing temperatures.

Batches are regularly load tested in the Oxford Plastics test facility as part of the quality control process.

TRACING

Products have a waterproof label with a unique bar code and ID number, enabling tracing to the batch and date of manufacture.

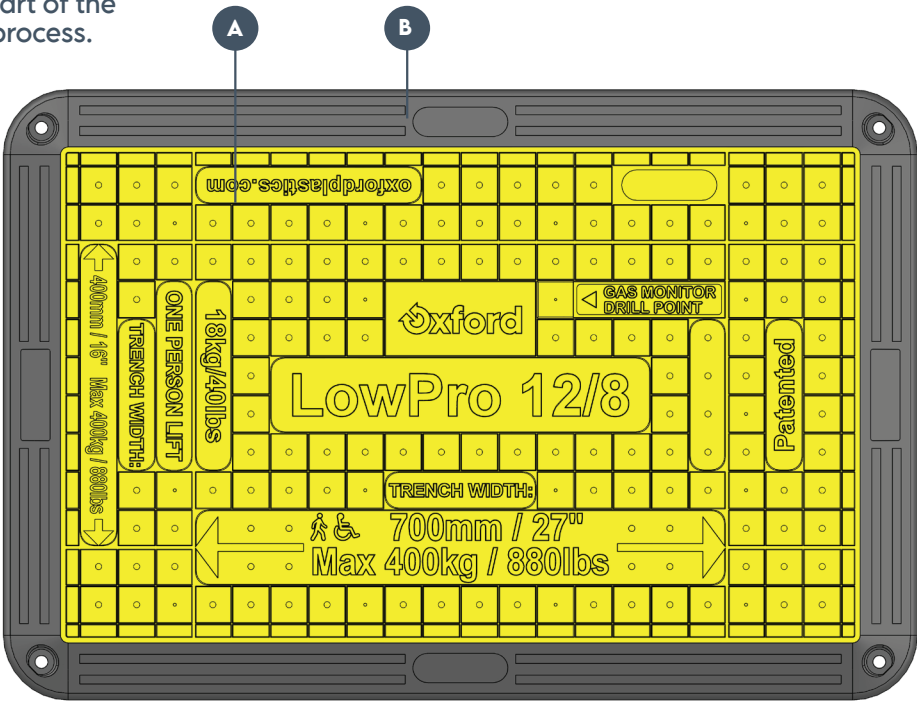

	Part Name	Material
A	Main Body	Glass fibre reinforced polyester resin sheet moulding compound + Mild Steel encapsulated rebar grid
B	LowPro-Edge	PVC





LOAD DEFLECTION DATA

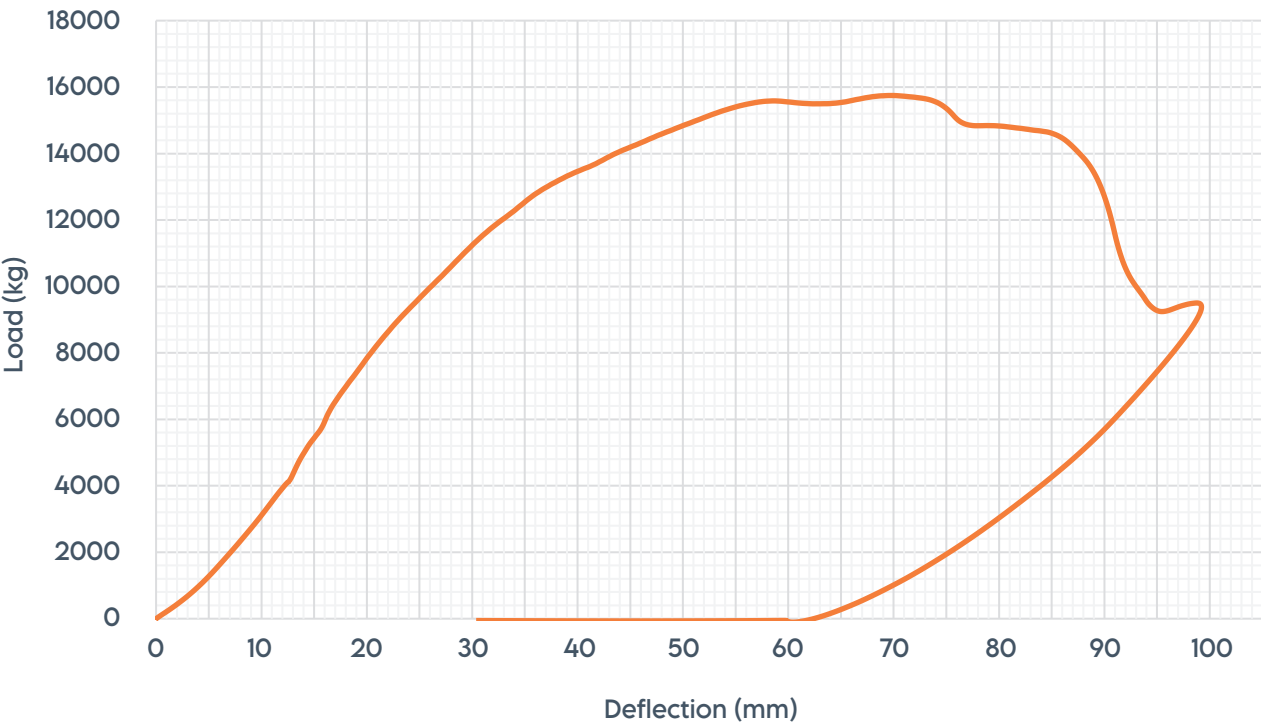

Deflection at 400kg / 880lb

12.5mm / 0.5"

Ultimate load at failure

15600kg / 3,439lb

Destructive testing has been carried out on the product to simulate deflection under the working load, and ultimate failure.

The testing is carried out by trained staff at Oxford Plastics' specialist testing facility.

PRODUCT RATING

The product is rated for use over spans of maximum 700mm / 27" by pedestrians with a total weight of up to

400kg / 880lb

TEST SPECIFICATION

Span
700mm / 27"

Load Footprint
250mm / 9.8" diameter pad with rubber base.

Load Location
Centre of product.





PEDESTRIAN ONLY USAGE

For scenarios where the product will only experience loads of up to 400Kg, the maximum span is 700mm.

The installer should carry out a risk assessment to ensure the edge of the trench is stable enough. For example, for excavations in concrete, asphalt or compacted soil.

The product must be positioned centrally on the trench.

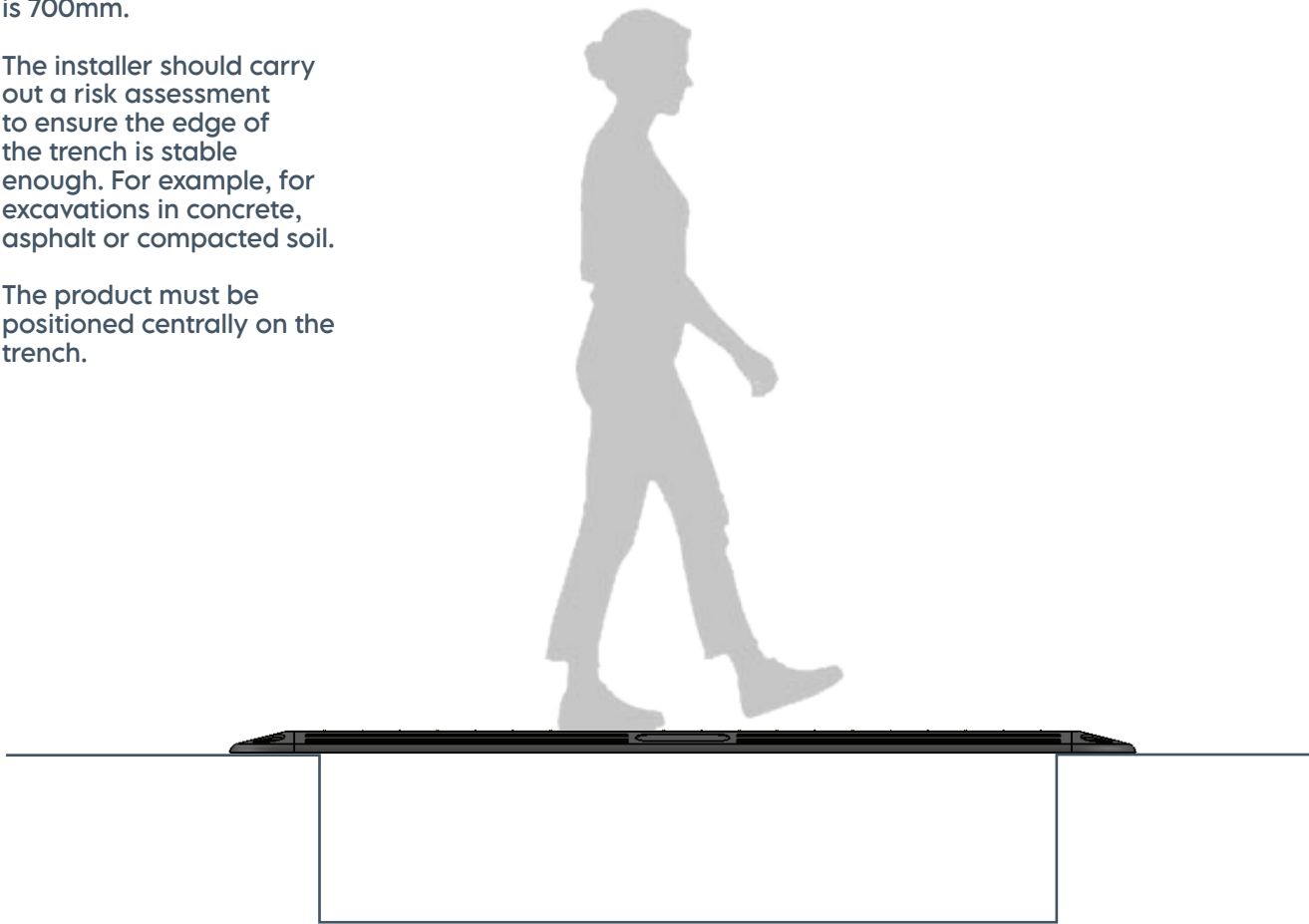

PEDESTRIAN ONLY USE	Metric	Imperial
Max Span	700mm	27"
Max Load	400Kg	880lb



SLIP RESISTANCE

Slip Resistance testing has been carried out by an independent test house, in line with the requirements of UK HSE 2012 document 'Testing the slip resistance of flooring'.

Testing was carried out in 3 directions in wet and dry conditions, using a calibrated Munro slip tester using Slider 55 and Slider 96.



CLASSIFICATIONS

High Slip Potential
0-24

Medium Slip Potential
25-35

Low Slip Potential
36+

SLIDER 96 TEST RESULTS - DRY

	Median Result	Classification
Parallel to traffic	59	LOW SLIP POTENTIAL
45 degrees to traffic	57	LOW SLIP POTENTIAL
Perpendicular to traffic	65	LOW SLIP POTENTIAL

SLIDER 96 TEST RESULTS - WET

Parallel to traffic	31	MODERATE SLIP POTENTIAL
45 degrees to traffic	40	LOW SLIP POTENTIAL
Perpendicular to traffic	34	MODERATE SLIP POTENTIAL

SLIDER 55 TEST RESULTS - DRY

Parallel to traffic	86	LOW SLIP POTENTIAL
45 degrees to traffic	92	LOW SLIP POTENTIAL
Perpendicular to traffic	85	LOW SLIP POTENTIAL

SLIDER 55 TEST RESULTS - WET

Parallel to traffic	51	LOW SLIP POTENTIAL
45 degrees to traffic	45	LOW SLIP POTENTIAL
Perpendicular to traffic	42	LOW SLIP POTENTIAL



INSPECTION AND MAINTENANCE

Care for the product by following the below guidance:

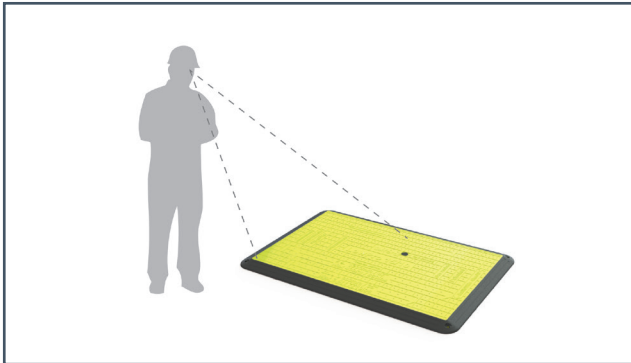

Inspect each product for signs of damage, between every installation.

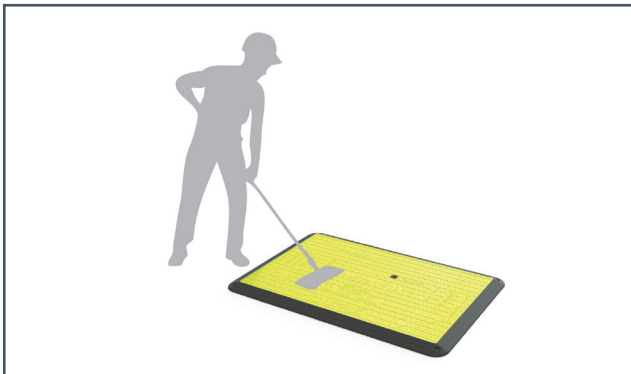

Clean product between every installation to remove debris, and to maintain slip resistance properties.

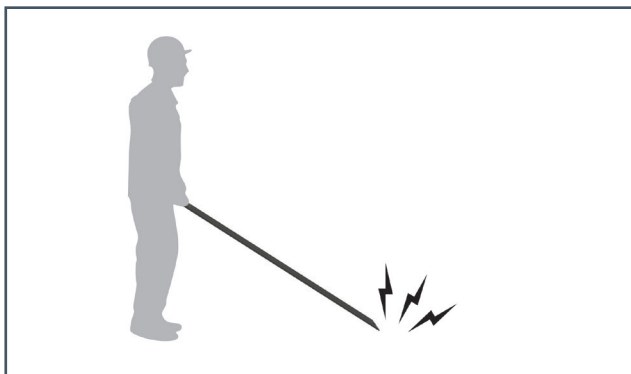

Do not drop the product.
Do not lift or move with machinery.

SIGNS OF DAMAGE

Cracks in the yellow section indicate it has been damaged through improper use.

The product should lay flat on the ground. A visibly bent product also indicates it has been damaged through improper use.

These products need to be disposed of.

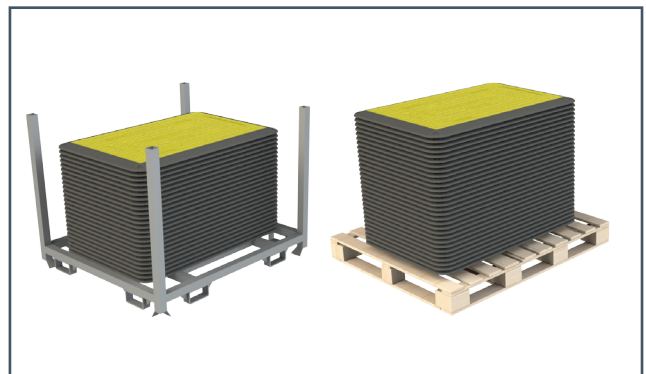

Stack 30 LowPro 12/8's onto a pallet, or 25 in the Stillage, for storage and transportation.





INSTALLATION AND SAFE HANDLING

Follow the process below for safe and effective installations.

Risk assessments should be carried out to ensure the usage is suitable for the scenario.

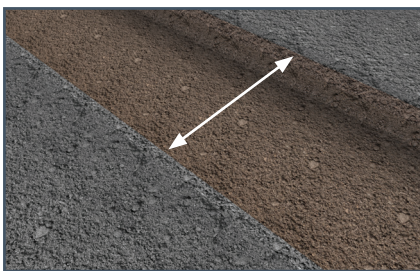

Confirm trench widths suitable:
LONG SIDE 700mm.
SHORT SIDE 400mm.

Assess Trench stability prior to install.

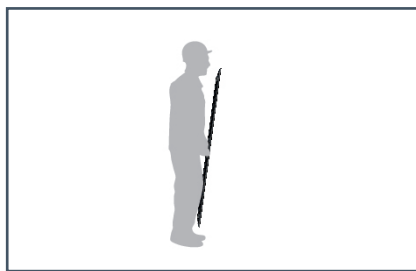

One person lift.



Bend at the knees in line with best practise.

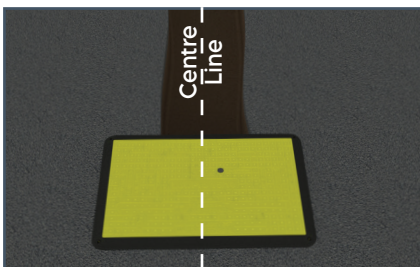

Position product centrally over trench..

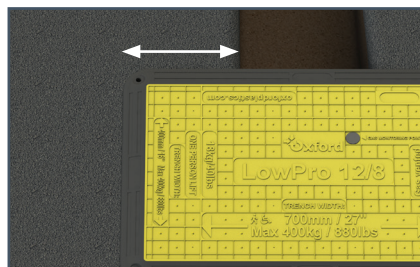

250mm overlap horizontally as shown.

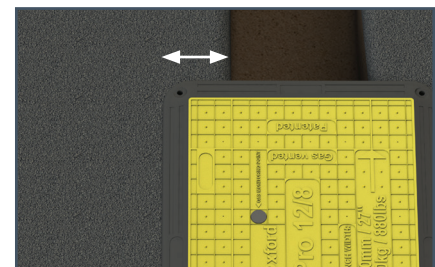

Rotated portrait, the maximum trench width is 400mm.
150mm overlap.
Do this for every piece.

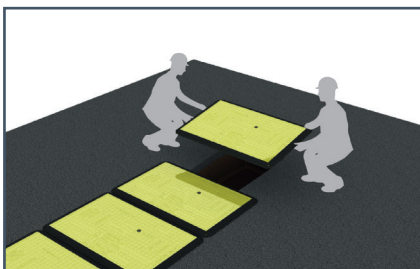

Repeat until the entire trench is covered.





INFILLS & LINKING PLATES

Infills remove the recess between boards when 2 or more are used.

The linking plates connect the Infills, and also link each Board together for added safety.

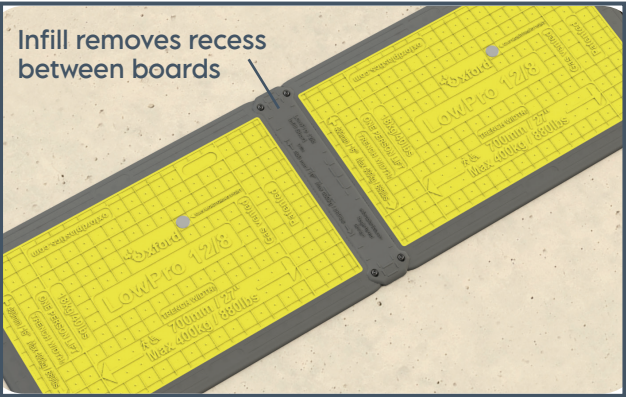

The short Infill is suitable for narrow trenches, where LowPros are installed landscape.

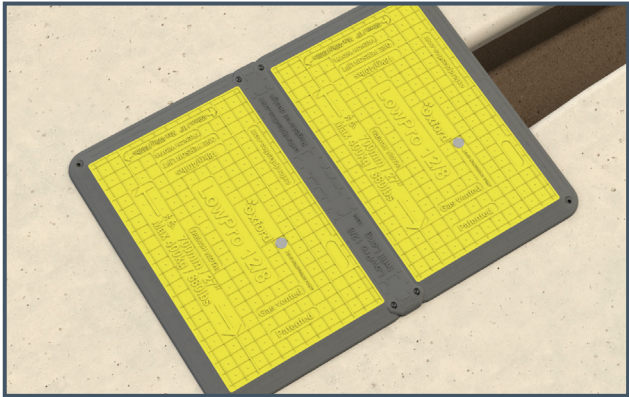

The long Infill is suitable for wider trenches, where LowPros are installed portrait.

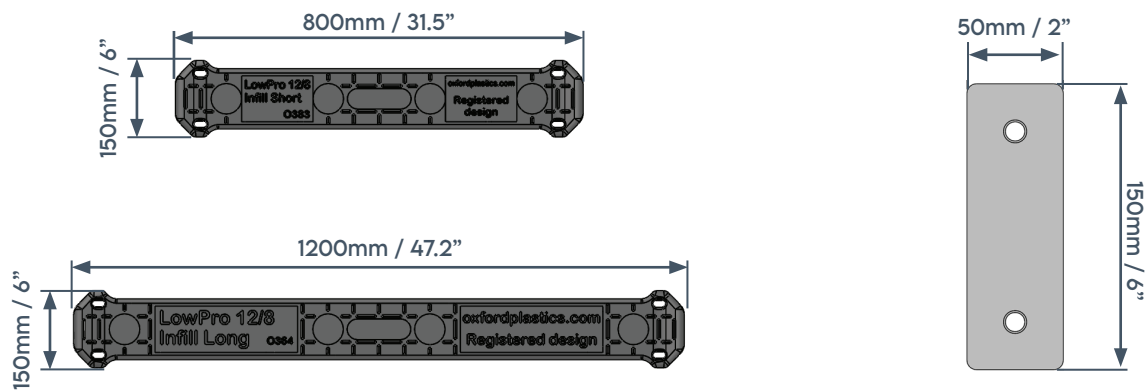

Part Name	Product Code	Material
Short Infill	O364	PVC
Long Infill	O383	PVC
Connector Plate	Supplied with the Infill	Zinc Plated Steel
Connector Plate Bolts	Supplied with the Infill	M10 x 20 hex head flanged bolt with zinc yellow coating

INFILL INSTALLATION

Follow the process below for safe and effective installations.

Risk assessments should be carried out to ensure the usage is suitable for the scenario.

LowPro Infills are for temporary applications. Infills should be checked for flatness on a routine basis and in the event of significant ambient temperature changes.

For long-term applications, LowPro Infills should be secured with screws to the LowPro Trench Cover edging every 100mm.

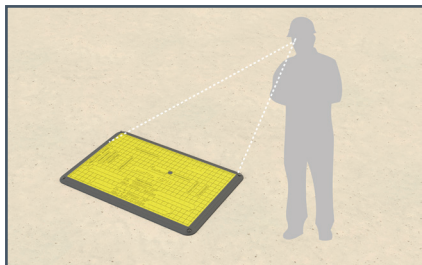

1. Assess the surrounding surface where the LowPro edges will be resting.



2. Unscrew the plate and bolts at each end of the Infill.

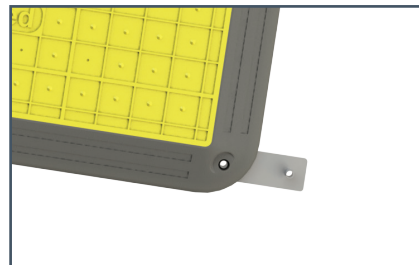

3. Insert the plate underneath the LowPro through the bolt hole.

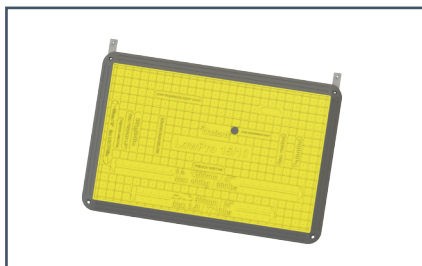

4. Insert the 2nd plate in the bolt hole on the long or short side.

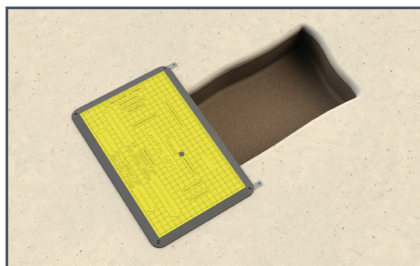

5. Place the LowPro with the plates centred over the width of the trench.



6. Place the next LowPro in line with first over the Infill plate.

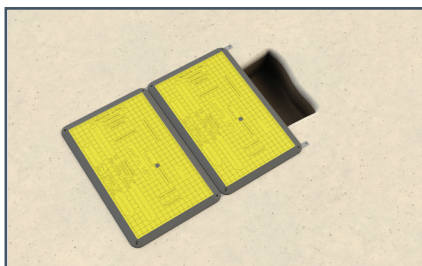

7. Ensure the LowPro is sitting on the plate at both ends.

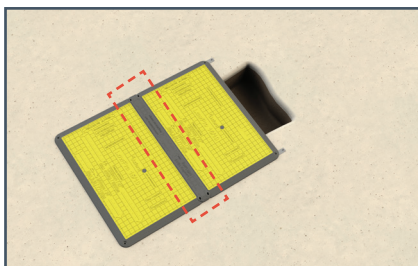

8. Place the Infill between the LowPros & secure with 2 bolts at either end.

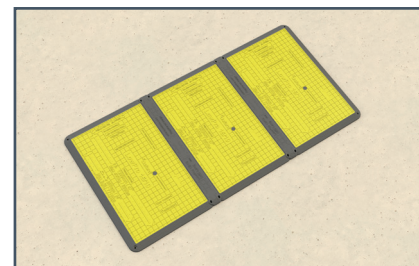

9. Continue placing LowPros over the trench & attaching Infills until the trench is fully covered.



STILLAGE

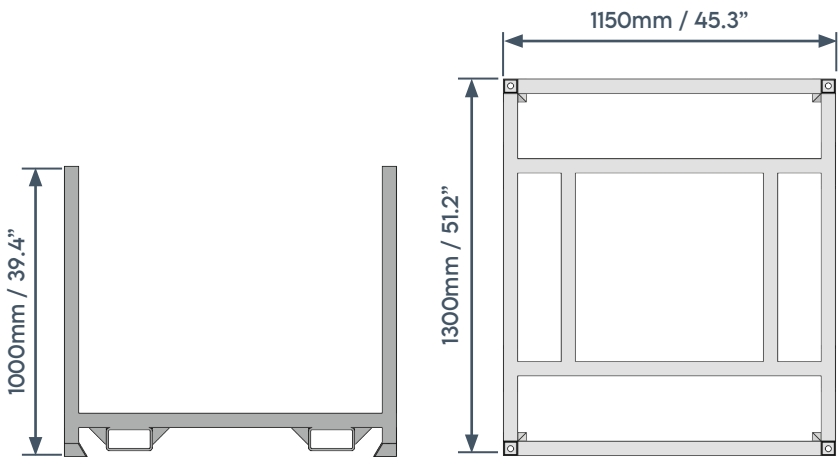

FEATURES AND BENEFITS

- Stack 25 LowPro 12/8's on a stillage
- Stack stillages on top of one another
- Comes with forklift pockets
- Durable steel material
- Galvanised for protection from rust

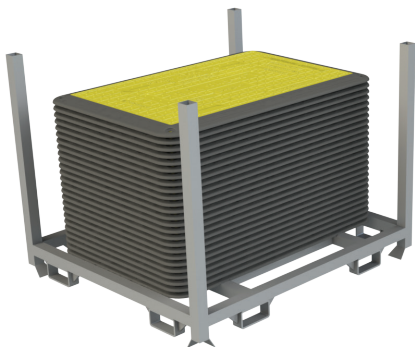

Stillage shown with 25 LowPro 12/8

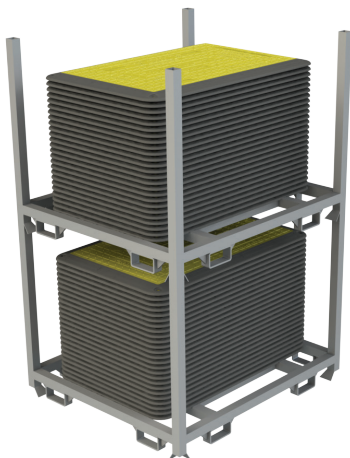

2 laden stillages shown stacked

LOWPRO STILLAGE

Product Code	5513
Tool Code	0746
Weight	77kg / 169lbs
Finish	Galvanised
Quantity / Pallet	1
No. of 12/8's per Stillage	25
Weight of loaded Stillage	527kg / 1161lbs



ASSOCIATED PRODUCTS

When setting up a street works site, other Oxford Plastics solutions can be used to ensure compliance is achieved. Browse our Chapter 8 solutions; including advanced barrier systems, trench covers, road plates, wheelchair ramps and street works signs.



**ADVANCED
BARRIER SYSTEMS**



**PORTABLE
GATE BARRIERS**



**STREET WORKS
SIGNS**



**WHEELCHAIR
RAMPS**



**TRENCH
COVERS**

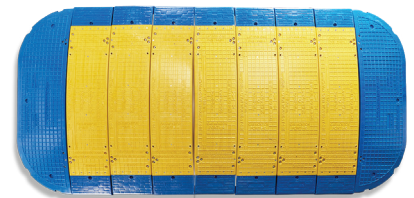











**ROAD
PLATES**

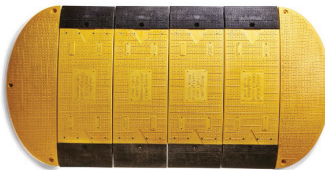

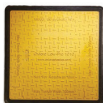
TRENCH COVER GUIDE

COMPOSITE TRENCH COVERS CAN BE INSTALLED IN THE FOLLOWING SCENARIOS.

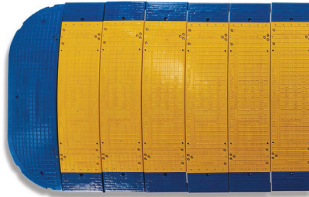
- ▶ A Site Safety Risk Assessment must be carried out before installation, only install on compacted surfaces such as concrete or asphalt. Always place the trench cover centrally over the excavation.
- ▶ In some instances, road plates and trench covers must be bolted for safety, refer to the installation guide for more details.
- ▶ Trench covers have a maximum width allowance.
- ▶ Trench covers can be linked together to safely cover any length of excavation.
- ▶ The LowPro range is HAUC Compliant.
- ▶ LowPro 15/05 and LowPro 23/05 are HS20-44 load rated.
- ▶ Trench covers must be installed centrally over the trench.

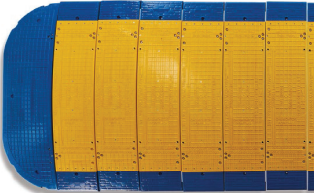
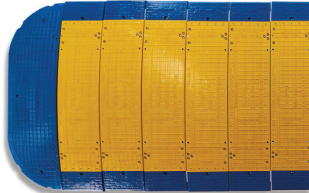
MAXIMUM TRENCH WIDTH ▼	WHAT TYPE OF TRAFFIC WILL CROSS THE TRENCH?		
	FOOTWAY 400KG / 880LBS ▼	DRIVEWAY 3.5T / 7715LBS VEHICLE ▼	ROADWAY 44T / 97000LBS VEHICLE ▼
100 ^{MM} 4"	 LowPro 100	 LowPro 100	 LowPro 15/05
700 ^{MM} 2 ^{FT}	 LowPro 12/8  LowPro 11/11	 LowPro 15/10	 LowPro 15/05
900 ^{MM} 3 ^{FT}	 LowPro 15/10	 LowPro 15/10	 LowPro 23/05
1200 ^{MM} 4 ^{FT}	 LowPro 15/10	 LowPro 23/05	 LowPro 23/05





CODE COMPLIANCE

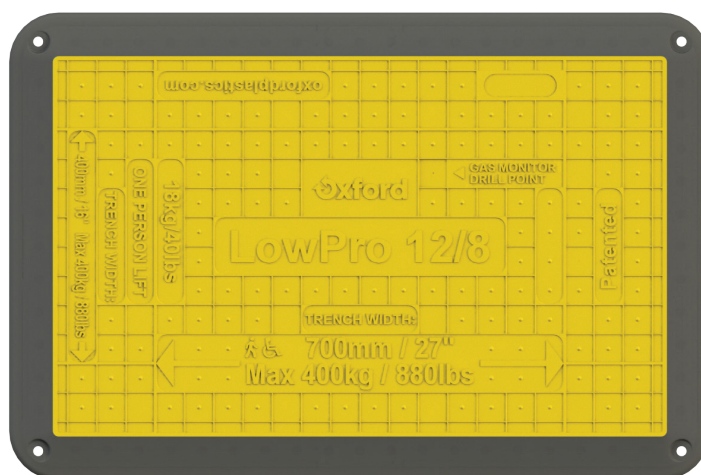
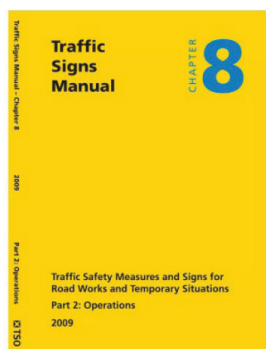
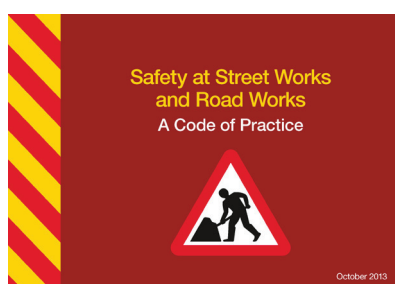

WHAT IS REGULATORY COMPLIANCE?

The Street Works manual, or red book tells contractors how to set up their street works site in a compliant manner. HAUC tell manufactures how to make compliant products. Oxford Plastics design composite trench covers that are 100% compliant with HAUC 2018/01 advice note - SPECIFICATION AND OPERATIONAL REQUIREMENTS FOR FOOTWAY BOARDS, DRIVEWAY BOARDS, FOOTWAY RAMPS AND ROAD PLATES, Department for Transport - Safety At Street Works And Road Works – A Code Of Practice, Department for Transport TAL 6/14 - Using road plates at road works.

The LowPro 12/8 Trench Cover is compliant with the above regulations for streetworks use.





HISTORY OF USE

Our composite Road Plates and Trench Covers have been used extensively:



METROPOLITAN USERS

London
New York
Paris
Munich
Seoul
Madrid
San Francisco
Tokyo
Sydney



Quality
You Can
Build On



Your Gas Network

UTILITY USERS

Gas
Water
Telecoms
Electricity





COMPOSITE ROAD PLATE & TRENCH COVER SALES

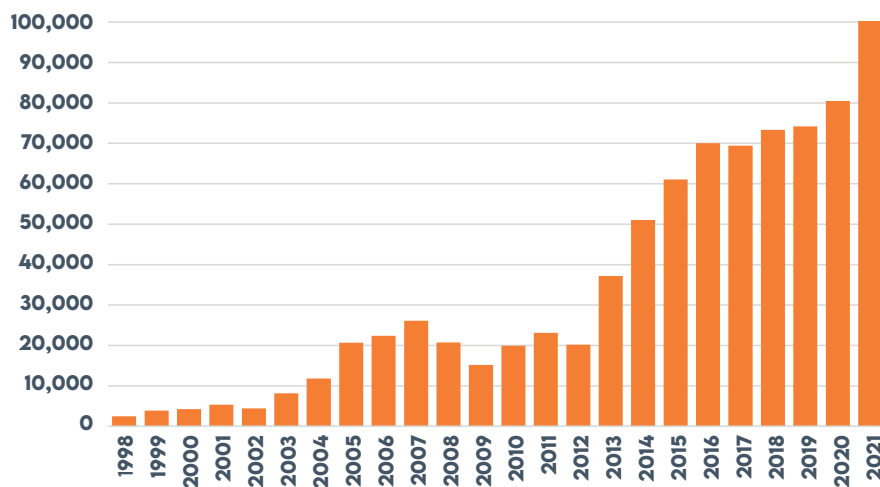

UNIT SALES

First concepts and products launched

1998

Worldwide sales since launch

+£54m

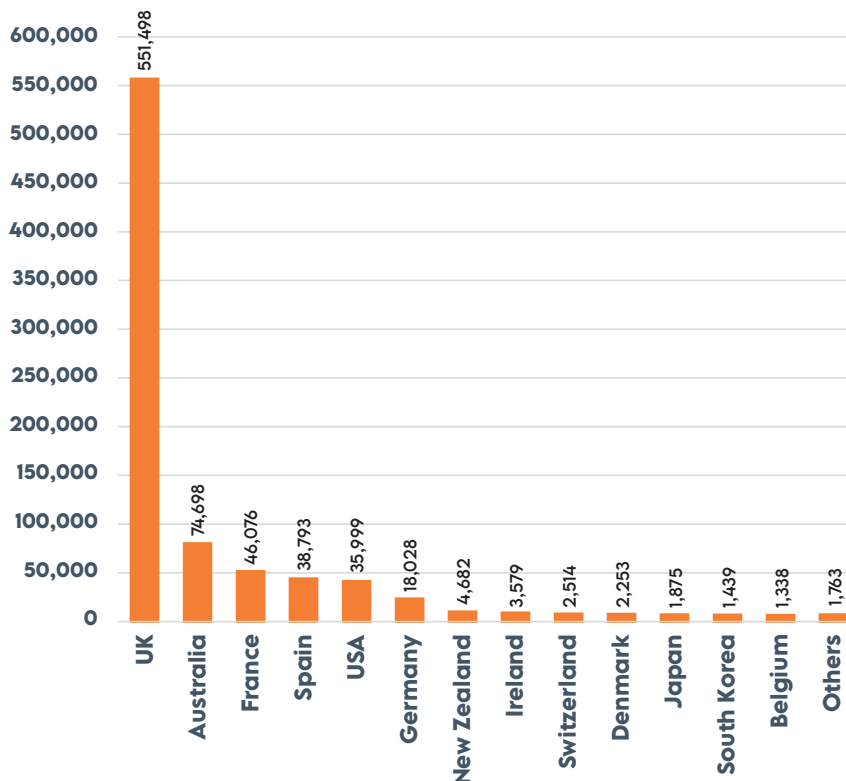

UNIT SALES BY COUNTRY

Countries using composite Road Plates and Trench Covers

42

Installations globally

+784k





CONTACT INFORMATION

UK & R.O.W

Oxford Plastic Systems Ltd
Unit T2, Enstone Business Park
Enstone,
Chipping Norton
Oxfordshire
OX7 4NP
United Kingdom

sales@oxfordplastics.com
Tel: +44(0)1608 678888

USA

Oxford Plastic Systems LLC
1011 Centre Rd,
Suite 312,
Wilmington
DE
19805
USA

info@oxfordplasticsusa.com
1-800-567-9182

